

# BOP Specifications 9" 3000 PSI

[www.BuyRigs.com](http://www.BuyRigs.com)

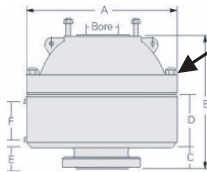

Annular Preventor



One 9 inch, 3000 PSI Type 90 Annular Blow out preventor complete with 1 3/8 inch B7 studs and nuts (flanged on bottom - studded on top)

| Model | Bore Size (inch) | Working Pressure (psi) | Testing Pressure (psi) | Close volume (l) | Open Volume (l) | Dimensions (mm) |     |     |     |    |     | Weight (kg) | Hydraulic Conn. |
|-------|------------------|------------------------|------------------------|------------------|-----------------|-----------------|-----|-----|-----|----|-----|-------------|-----------------|
|       |                  |                        |                        |                  |                 | A               | B   | C   | D   | E  | F   |             |                 |
|       | 9                | 3000                   | 6000                   | 34               | 22.8            | 902             | 838 | 128 | 494 | 48 | 260 | 2398        | NPT 1"          |

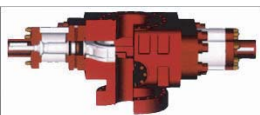

Ram Preventor

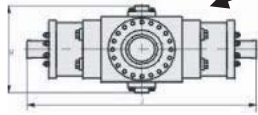

One 9 inch, 3000 PSI Type 88 Single Gate ram preventors with blind rams (CSO) complete with 1 3/8 inch B7 studs and nuts (RTJ on top and bottom - R49 Ring Gasket)

| Model | Bore (in) | W.P (psi) | Weight (kg) | Dimensions (mm) |     |     | Connection |         |
|-------|-----------|-----------|-------------|-----------------|-----|-----|------------|---------|
|       |           |           |             | L               | W   | H   | Top        | Bottom  |
|       | 9         | 3000      | 820         | 1708            | 580 | 280 | studded    | studded |

Note: Pictures show stud by flange, we have stud by stud.



Fill / Kill Spool

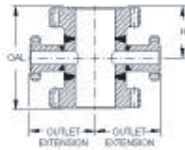

One Kill / Flare Spool - 9 inch, 3000 PSI (R49 Ring Gasket) x 9 inch 3000 PSI (R49 Ring Gasket) with (2) 3 inch 3000 psi flanged (R31 Ring Gasket) side outlets



Ram Preventor

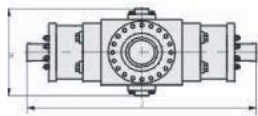

One 9 inch, 3000 PSI Type 88 Single Gate ram preventors with 4" pipe rams complete with 1 3/8 inch B7 studs and nuts (RTJ on top and bottom - R49 Ring Gasket)

| Model | Bore (in) | W.P (psi) | Weight (kg) | Dimensions (mm) |     |     | Connection |         |
|-------|-----------|-----------|-------------|-----------------|-----|-----|------------|---------|
|       |           |           |             | L               | W   | H   | Top        | Bottom  |
|       | 9         | 3000      | 820         | 1708            | 580 | 280 | studded    | studded |



Adaptor Spool

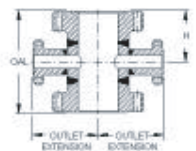

One Adaptor Spool - 9 inch, 3000 PSI (R49 Ring Gasket) x 9 inch 3000 PSI (R49 Ring Gasket) with (2) 2 inch 3000 psi flanged side outlets

All hydraulic connection to be threaded NPT. All studs, nuts, and ring gaskets to be British thread and size. All components to be API stamped and to NACE specifications

[www.BuyRigs.com](http://www.BuyRigs.com)